

**LÄNGSANSICHT**

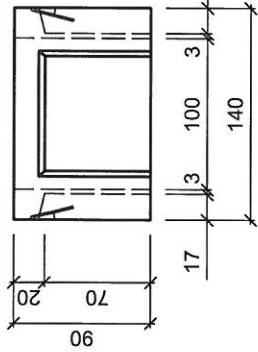

**QUERANSICHT**

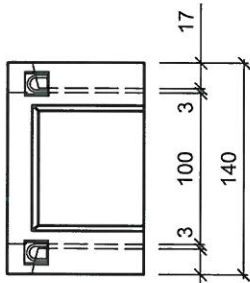

**GRUNDRISS**

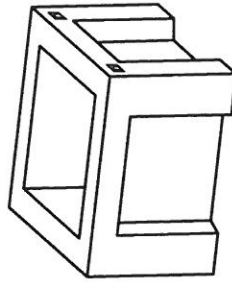
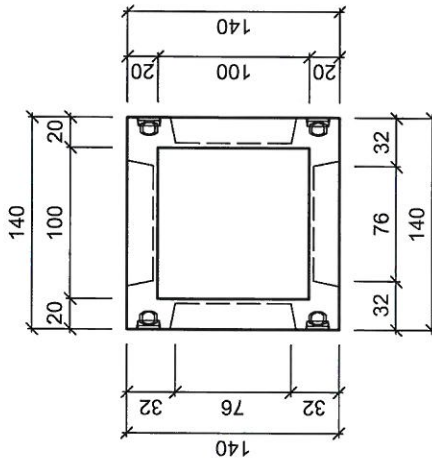

**Beschriftung:**

SN-90-2  
1110 Kg

je 2 Stk. Transportschlaufen auf der Querseite

Betonqualität: SN EN 206-1:2000; C50/60; XC4; XD3; XF4; Dmax. 16; CI 0.10; SF3

**STRADEC - Normschacht**

**Disposition**

SN-90-2



F. Borner AG, CH-6260 Reiden  
T 062 749 00 00, www.borner.ch

|            |             |                  |        |            |         |            |  |              |  |
|------------|-------------|------------------|--------|------------|---------|------------|--|--------------|--|
| Gezeichnet |             | Massstab<br>1:50 |        | Blatt<br>1 |         | Total<br>1 |  | Format<br>A4 |  |
| 1          | 23.04.12/KN | 23.04.12/KN      | Gepüft |            | Ausgabe |            |  |              |  |
| 2          | 26.11.12/KN | 26.11.12/KN      |        |            |         |            |  |              |  |
| 3          | 04.04.14/KN | 04.04.14/KN      |        |            |         |            |  |              |  |
| 4          |             |                  |        |            |         |            |  |              |  |

**115102**